

Isometric View

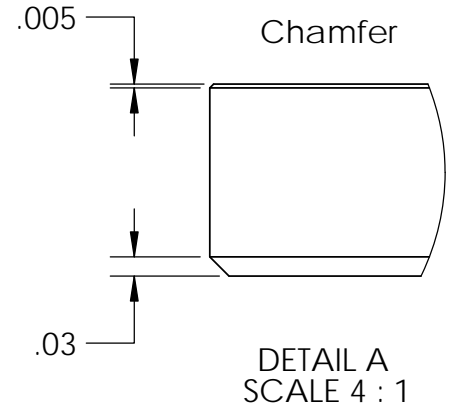
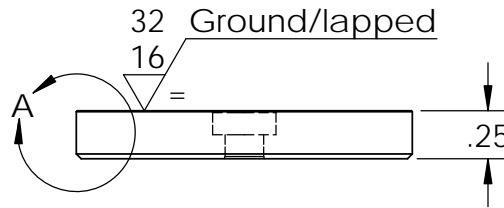
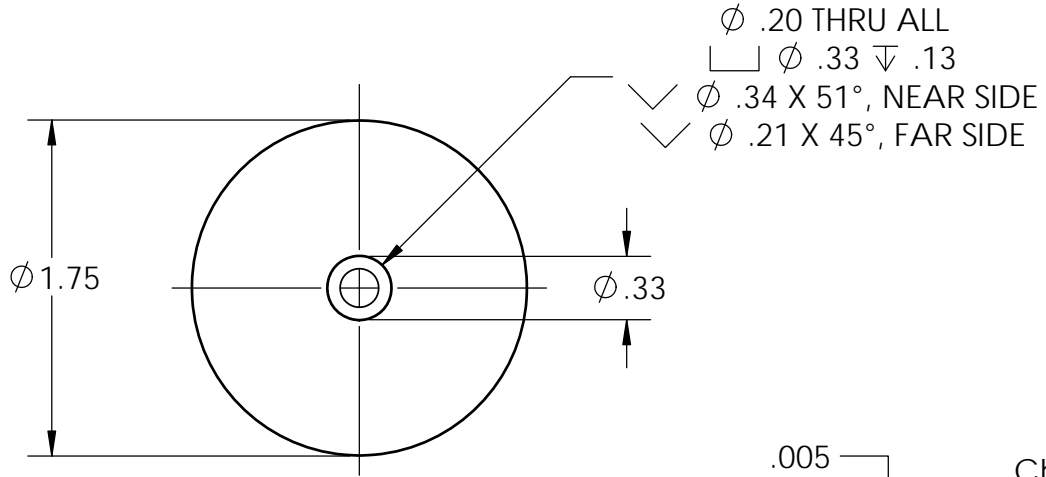

**Plating Details:**

**Process:** Electroless Nickel MID Phosphorous  
**Thickness:** 0.0002" to 0.0003"  
**Handling:** Must be individually Racked  
 (No barrel plating)

128 All surfaces unless indicated otherwise  
 64

**PROPRIETARY AND CONFIDENTIAL**  
 THE INFORMATION CONTAINED IN THIS DRAWING IS THE SOLE PROPERTY OF APW COMPANY. ANY REPRODUCTION IN PART OR AS A WHOLE WITHOUT THE WRITTEN PERMISSION OF APW COMPANY IS PROHIBITED.

		UNLESS OTHERWISE SPECIFIED:		NAME	DATE	<b>APW COMPANY</b>		
		DIMENSIONS ARE IN INCHES TOLERANCES: FRACTIONAL ± .015 ANGULAR: MACH ± 2 BEND ± 2 TWO PLACE DECIMAL ± .010 THREE PLACE DECIMAL ± .005	DRAWN	J.K.	07.09.13			TITLE:
		INTERPRET GEOMETRIC TOLERANCING PER: ANSI	CHECKED	J.K.	07.09.13	Strike Plate EM175		
		MATERIAL 1215 CRS	ENG APPR.	J.K.	07.09.13			SIZE
		FINISH	MFG APPR.	J.K.	07.12.13	<b>A</b>	<b>SP-175</b>	
NEXT ASSY	USED ON		Q.A.			SCALE: 1:1	WEIGHT:	SHEET 1 OF 1
APPLICATION		DO NOT SCALE DRAWING	COMMENTS:					